

LEGEND:
 — LANDOWNERSHIP BOUNDARY
 — PLANNING APPLICATION BOUNDARY

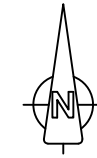

OSI © Licence: CYAL50441216 - OS Map Ref: No. 4588-B, 4588-D, 4589, 4590-A, 4590, 4648, 4649-A, 4649-C, 4649-E, 4649-D, 4708-B, 4709-A & 4709-B - Prepared Using Irish Transverse Mercator (ITM)

Date:	Rev:	Description:	Drawn By:

Prepared By:



Galetech Energy Services
 Clondangan, Stradone
 Co. Cavan, H12 NV06
 info@galetechenergyservices.com
 www.galetechenergyservices.com

Client: **WHITE HILL WIND LIMITED**

Job Title: **White Hill Wind Farm Electricity Substation & Electricity Line**

Drawing Title: **FIGURE 1.01: OVERALL SITE LOCATION (1:50,000)**

Drawing No.: WHI001SS_PLAN_LOC-0.01	Stage: PLANNING
Scale: (A3) 1:50,000	Date: 04/03/2025
Drawn By: EF	Checked By: JB
	Revision No.: REV 02
	Confirmed By: SC

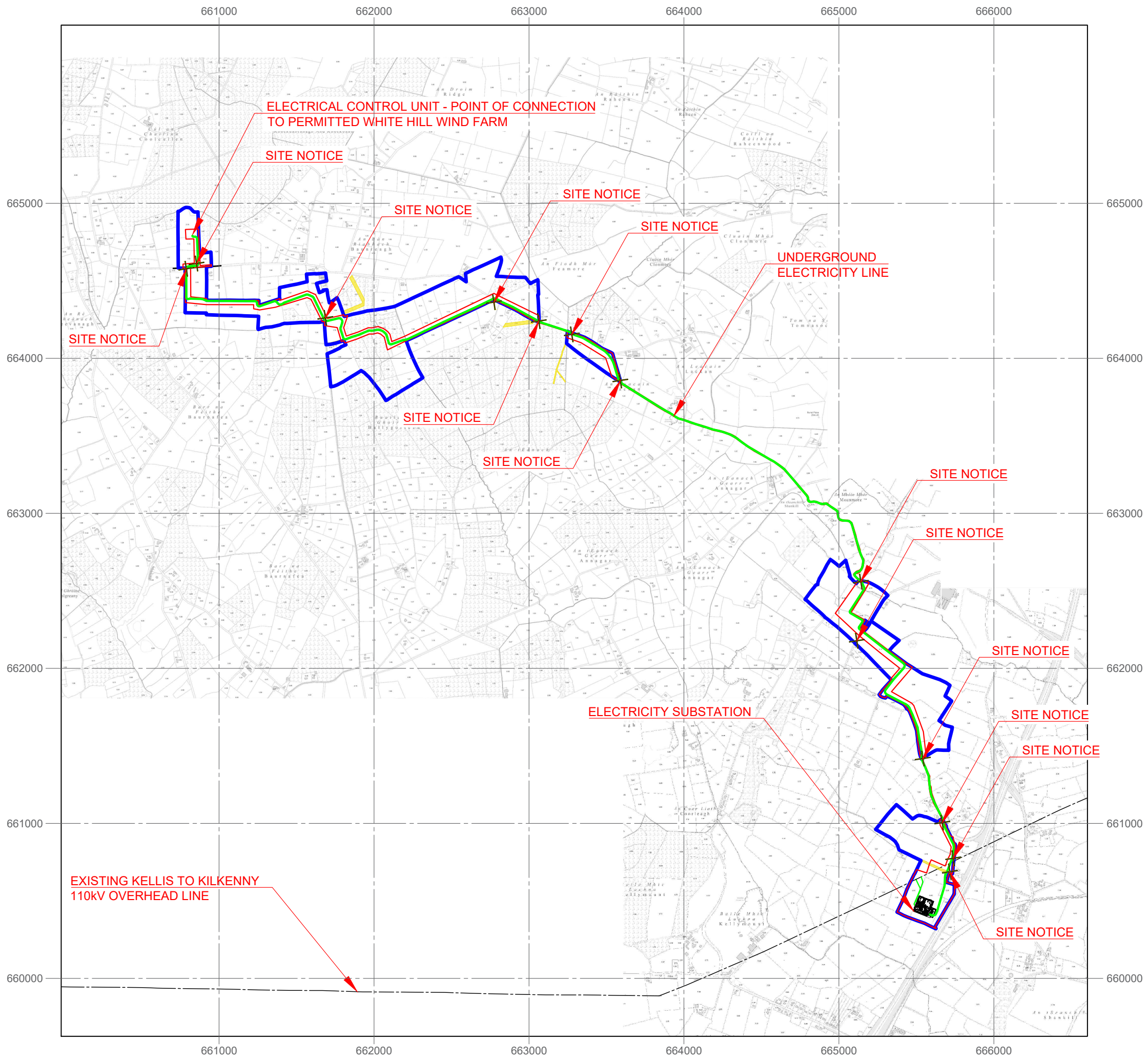

LEGEND:

	LANDOWNERSHIP BOUNDARY
	PLANNING APPLICATION BOUNDARY
	UNDERGROUND ELECTRICITY LINE
	EXISTING WAYLEAVE
	SPOT HEIGHT

- NOTES:**
1. ALL DIMENSIONS MUST BE CHECKED ON SITE AND NOT SCALED FROM THIS DRAWING.
 2. ALL DIMENSIONS IN METRES UNLESS OTHERWISE STATED.
 3. DIMENSIONS MAY IMMATERIALLY VARY DEPENDING ON SITE CONDITIONS.
 4. WHILE THE PRECISE SITING OF INFRASTRUCTURE MAY IMMATERIALLY DEVIATE FROM THAT ILLUSTRATED, ALL INFRASTRUCTURE SHALL BE LOCATED WITHIN THE APPLICATION BOUNDARY.

OSI © Licence: CYAL50441216 - OS Map Ref: No. 4588-B, 4588-D, 4589, 4590-A, 4590, 4648, 4649-A, 4649-C, 4649-B, 4649-D, 4708-B, 4709-A & 4709-B - Prepared Using Irish Transverse Mercator (ITM).

Date:	Rev:	Description:	Drawn By:

Prepared By:



Galetech Energy Services
Clondargan, Stradone
Co. Cavan, H12 NV06
info@galetechenergyservices.com
www.galetechenergyservices.com

Client: **WHITE HILL WIND LIMITED**

Job Title: **White Hill Wind Farm Electricity Substation & Electricity Line**

Drawing Title: **FIGURE 2.01: SITE LOCATION PLAN (1:25,000)**

Drawing No.: WHI001SS_PLAN_LOC-0.02	Stage: PLANNING
Scale: (A3) 1:25,000	Date: 04/03/2025
Drawn By: EF	Checked By: JB
	Confirmed By: SC

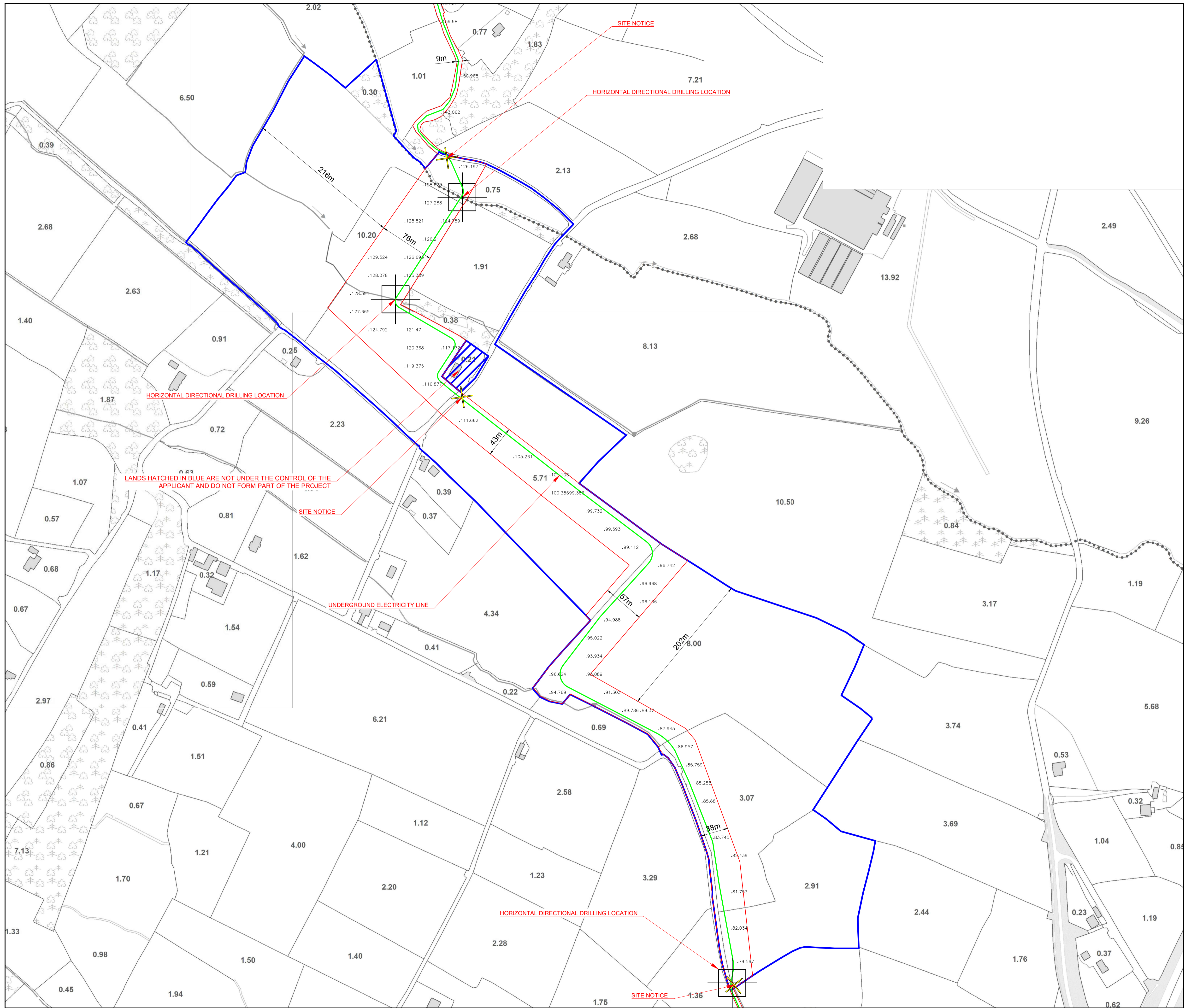

- LEGEND:**
- LANDOWNERSHIP BOUNDARY
 - PLANNING APPLICATION BOUNDARY
 - UNDERGROUND ELECTRICITY LINE
 - EXISTING WAYLEAVE
 - + SPOT HEIGHT

- NOTES:**
1. ALL DIMENSIONS MUST BE CHECKED ON SITE AND NOT SCALED FROM THIS DRAWING.
 2. ALL DIMENSIONS IN METRES UNLESS OTHERWISE STATED.
 3. DIMENSIONS MAY IMMATERIALLY VARY DEPENDING ON SITE CONDITIONS.
 4. WHILE THE PRECISE SITING OF INFRASTRUCTURE MAY IMMATERIALLY DEVIATE FROM THAT ILLUSTRATED, ALL INFRASTRUCTURE SHALL BE LOCATED WITHIN THE APPLICATION BOUNDARY.

OSI Licence: CYAL50441216 - OS Map Ref. No. 4588-B, 4588-D, 4589, 4590-A, 4590, 4648, 4649-A, 4649-C, 4649-B, 4649-D, 4708-B, 4709-A & 4709-B - Prepared Using Irish Transverse Mercator (ITM).

Date:	Rev:	Description:	Drawn By:

Prepared By:



Galetech Energy Services
Clondorgan, Stradone
Co. Cavan, H12 NV06
info@galetechenergyservices.com
www.galetechenergyservices.com

Client: **WHITE HILL WIND LIMITED**

Job Title: **White Hill Wind Farm Electricity Substation & Electricity Line**

Drawing Title: **FIGURE 4.04: SITE LOCATION PLAN 4 OF 5 (1:2,500)**

Drawing No. WHI001SS_PLAN_LOC-0.07	Stage. PLANNING	
Scale: (A1) 1:2500	Date: 04/03/2025	Revision No.: REV 02
Drawn By: EF	Checked By: JB	Confirmed By: SC

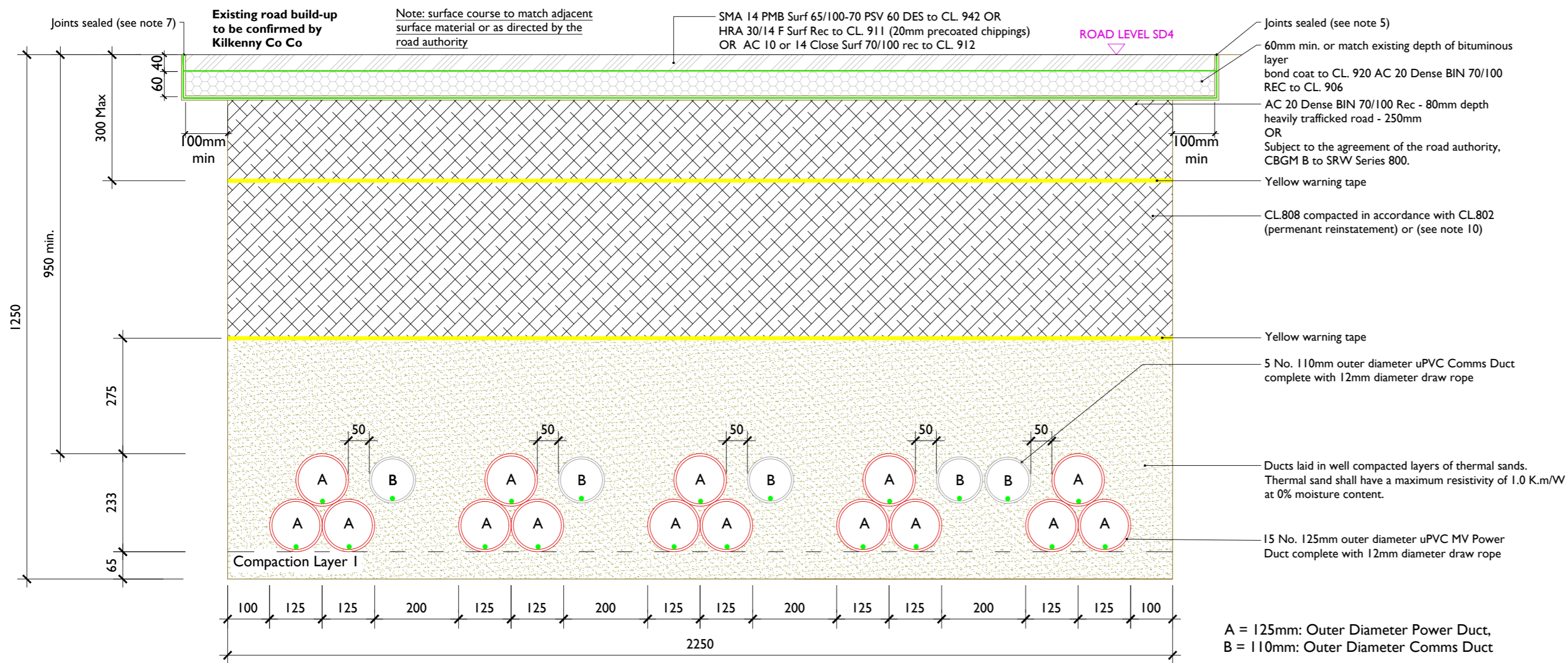

Section Through Permanent Reinstatement of Longitudinal Opening In Roadway

SCALE 1:10

ALL REINSTATEMENT WORKS ARE TO BE IN ACCORDANCE WITH LOCAL AREA ENGINEERS REQUIREMENTS AND GUIDELINES FOR MANAGING OPENINGS IN PUBLIC ROADS

- Note:
- Refer to Guidelines for managing Openings in Public Roads (Purple Book - April 2017), Chapter 6 'Specifications' for guidance on Duct type / colour and Marker Tape type / colour.
 - All bound edges shall be saw cut to expose the full vertical thickness of each layer prior to excavation. All edges shall be essentially straight, smooth and vertical.
 - Where a temporary surface has been used, material shall be planed out to the depth specified in this drawing. The new permanent surface shall be machined laid and mechanically compacted with a vibrating roller.
 - Where the trimmed edge of excavation is within 400mm* of a joint / edge, ironwork or other reinstatement, this trimmed edge shall be extended to include same and the area of reinstatement shall be extended accordingly (* increase to 800mm where this is pre-existing practice).
 - Any damaged area adjacent to the opening and resulting from the excavation operation shall be included within the area to be reinstated.
 - Clause 808 or Cement Bound Granular Material surface to be sprayed per clause 920 prior to application of Asphalt Concrete Layer.
 - Joint sealer shall be a hot 50 pen bitumen binder or cold thixotropic bitumen 50 -70 pen to be applied to all vertical cuts in accordance with B.S.594987 prior to application of bituminous materials.
 - For roads without asphalt concrete surface (e.g. may be Cl.804 with double surface dressing), the road authority may as its discretion permit the temporary reinstatement surface of asphalt concrete to be regulated in lieu of excavation and reinstatement; and subsequently surface dressed.
 - On highly trafficked roads services must have a minimum cover of 750mm.
 - Where required by the Road authority the trench may be reinstated with a Cement Bound Granular Material.
 - Full carriage way reinstatement will be carried out where the cable is in the local public road

PROJECT

**White Hill Wind Farm
Grid Connection**

CLIENT

White Hill Wind Limited

CONSULTANTS



NOTES: -

- This drawing is to be read in conjunction with relevant drawings, specifications and reports
- Dimensions are in millimeters, unless noted otherwise
- Drawings are not to be scaled use figured dimensions only
- Hand excavation only above pipeline crossing sections

LEGEND: -

ISSUE/REVISION

I/R	DATE	DESCRIPTION
P1	01.07.25	Issued for Planning

PROJECT NUMBER

300-101087

SHEET TITLE

Section through Roadway

SHEET NUMBER

300101087-DR-122